

// NEW: Dark Oak Timber Design



Internal Doors

A Wide Range for All Applications in the Non-Domestic Building Sector



With Hörmann internal doors you can confidently carry out your building plans

For new construction and modernisation, Hörmann offers you doors for all building areas in steel, steel/timber and aluminium – all from one source. High quality, colour design and a wide variety of equipment options characterise this programme.





Reference Projects	4
ZK Doors, quality features	6
OIT Doors, quality features	8
AZ 40 Doors, quality features	10
A wide choice of colours	12
Window sections, glazing, handles	14
Dimensions, fitting data	16
Overview of the steel frame range	18

The colours and surface finishes shown are subject to the limitations of the printing process and cannot be regarded as binding.

All rights reserved. No part of this brochure may be reproduced without prior permission. Subject to changes.

Variety Is Our Strength We Gear Ourselves to Your Wishes

Hörmann internal doors meet all the demands placed on doors for constructions projects: attractive aesthetics, a high degree of stability, thermal insulation, acoustic rating, smoke-tightness and security. Because Hörmann not only offers a diverse range but also excellent value for money.

Steel doors for a broad range of applications

Hörmann ZK and OIT internal doors are robust steel doors that come with a wide choice of equipment to meet the diverse requirements of construction projects.



The communal aluminium door

A door that lets you see from the outside whether a room is already occupied. A typical benefit of the AZ 40 aluminium door with its slimline profiles and extensive glazing.



Steel Internal Door ZK

Proven as a competitively-priced solution

Single and double-leaf

These doors have been used for decades in offices and administrative buildings, as well as in basements and loft conversions on account of their numerous benefits. They are robust, retain their shape and are highly durable. The high-grade surface is light-fast, as well as both heat and stain-resistant and it simply needs washing down, making it very easy to care for. Hörmann ZK doors are manufactured in large series. Consistently high quality with consistently low prices.

The hardwearing door leaf

Double-skinned, 40 mm thick, rebated on 3 sides (thick rebate). Galvanized sheet steel, 0.6 mm thick. The close-meshed honeycomb insert is glued to the two galvanized steel sheets over the entire surface, giving the door greater stability.

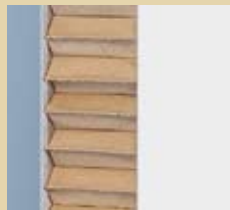

Honeycomb insert

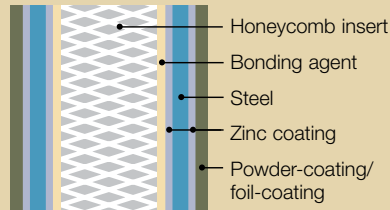

Easy to shorten up to 20 mm

The door leaf can be shortened at the bottom using a suitable saw, e.g. for renovations.

As a door leaf or door set

ZK doors are available as a ready-to-hang door leaf or as a complete ready-to-fit door set.

Door leaf

With fitted lock and bright-galvanized hinge top parts V 0020 firmly screwed into the reinforced sections, but without lever handle set.

Door set

Door leaf complete with lever handle set and standard special corner frame in galvanized, 1.5-mm-thick sheet steel, powder-coated and primed in Traffic white (based on RAL 9016).

Frame

PVC sealing profile on 3 sides, with welded frame parts and grouting lugs.

ZK doors can also be fitted into existing standard frames and of course into any Hörmann steel door frame (designed for hinges of the V 8000 series).

Dimensionally stable with no warping

ZK doors meet the high standards of the climatic class III and duty category S.

Smooth, quiet closing

Mortice lever/knob lock acc. to DIN 18251, class 3, prepared for profile cylinder (backset 55 mm). With plastic latch and steel bolt, deadlock insert and key. On request, also with profile cylinder.



As standard:

- **Climatic class III**
- **Duty category S**
- **Thermally insulated**
- **Acoustic-rated**



The top halves of the hinges are firmly screwed into the reinforced sections of the door leaf.



Due to the design of the door leaf and frame seal, Hörmann ZK doors also help to keep out noise and the cold.

Thermally insulated

EN ISO 12567-1

ZK doors provide a thermal insulation value of:
 $U = 2.1 \text{ W/m}^2 \text{ K}$

Acoustic-rated

DIN 52210

Door leaf with honeycomb insert
Acoustic value:
Rw approx. 25 dB (lab value).
Characteristic acoustic rating achievable on-site:
Laboratory value - 5 dB.

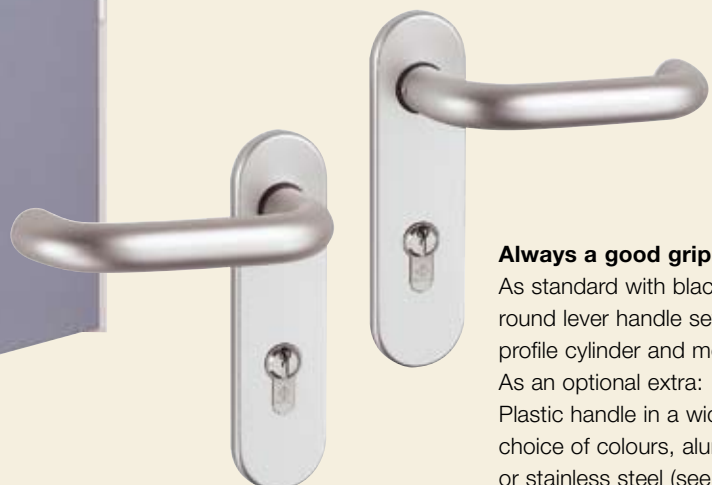

Always a good grip

As standard with black plastic round lever handle set for profile cylinder and mortice key.
As an optional extra:
Plastic handle in a wide choice of colours, aluminium or stainless steel (see also page 15).

Illustration:
ZK door in Window grey with white rose escutcheons (optional extra).

For high traffic use
in industry, trade, public
offices and schools

OIT Steel/Timber Internal Door

The Solid Internal Door

Single and double-leaf

OIT doors have been developed for tough everyday use in industrial and commercial buildings, workshops, administrative buildings, schools and barracks. In these sectors, doors are subjected to a great deal of wear and tear. This new door has been specifically designed to withstand this kind of rough treatment. That's what makes it so robust, dimensionally stable and hard-wearing. Depending on the application area and requirement profile, we offer OIT doors with a choice of infills.

The superior combination of timber and steel

Particularly sturdy door leaves in three infill variations

Double-skinned, 40 mm thick, rebated on 3 sides (thick rebate). The timber infills are completely covered with 0.8 mm thick sheet steel and are glued over the entire surface. The composite structure of these materials gives the door a high level of dimensional stability, as is called for in tough everyday use.

Also available with composite timber insert for improved acoustic insulation or mineral wool insert for improved thermal insulation on request.

Easy to shorten up to 20 mm
If adjustments need to be made in the height, the door leaf can be shortened at the steel profile (wood insert on request) using a suitable saw.

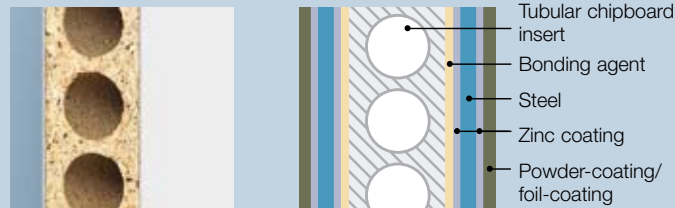

Tubular chipboard insert as standard

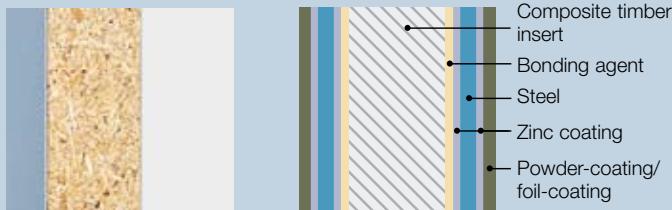

Composite timber insert on request

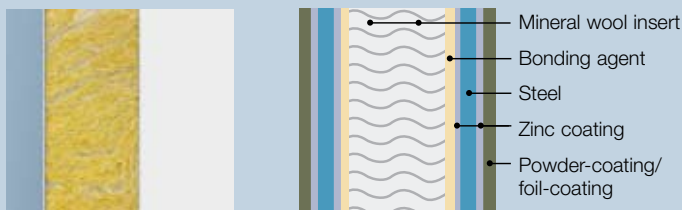

Mineral wool insert on request

As a door leaf or door set

OIT doors are available as a ready-to-hang door leaf or as a complete ready-to-fit door set.

Door leaf

With fitted lock and bright-galvanized hinge top parts V0026 WF firmly screwed into the reinforced sections, but without lever handle set.

Door set

Door leaf complete with lever handle set and standard special corner frame in galvanized 1.5-mm-thick sheet steel, powder-coated and primed in Traffic white (based on RAL 9016).

Frame

Acoustic-rated EPDM sealing profile on 3 sides, with welded frame parts and grouting lugs.

OIT doors can also be fitted into existing standard frames and of course into any Hörmann steel door frame.

Extremely robust and dimensionally stable

OIT doors meet the high standards of the climatic class III and duty category S and therefore always retain their shape.

Smooth, quiet-closing

Mortice lever/knob lock acc. to DIN 18251, class 3, prepared for profile cylinder (backset 55 mm). With plastic latch and steel bolt, deadlock insert and key. Also with profile cylinder on request.





Thermally insulated
DIN 52619

OIT doors provide excellent thermal insulation in all infill versions:
Tubular chipboard insert
 $U = 2.5 \text{ W/m}^2 \text{ K}$
Mineral wool insert
 $U = 1.7 \text{ W/m}^2 \text{ K}$

Illustration:
OIT door in Traffic white
with aluminium lever
handle set

As standard:

- **Climatic class III**
- **Duty category S**
- **Thermally insulated**
Depending on the equipment:
- **Acoustic-rated**
- **Break-in-resistant**



Maintenance-free, 3-part hinges, galvanised (standard).



Maintenance-free, 3-way adjustable VX hinges. Standard surface matt chrome finish F1 (on request).

Acoustic-rated
DIN EN 20 140

Door leaf with tubular chipboard or mineral wool insert
Acoustic value:
Rw approx. 32 dB (lab value)
SK I in connection with a retractable bottom seal.

Break-in-resistant
DIN EN V 1627 (WK2)

Break-in-resistant possible for all infill versions.

Special options

For door sets up to 1125 x 2125 mm, non-glazed, with retractable bottom seal.

Door leaf with solid chipboard
Acoustic value:
RwP approx. 38 dB (lab value)
SK II in connection with a retractable bottom seal.

Characteristic acoustic rating achievable on-site:
Laboratory value - 5 dB.

Special options

For door sets up to 1250 x 2250 mm, without glazing, with the following optional extras:

- Multiple locking with 2 additional steel bolts
- Profile cylinder, drill-proof acc. to DIN 18254, PZ-3-BS with 3 keys and security certificate for spare keys
- Aluminium lever/knob handle set acc. to DIN 18257 with short escutcheon (class ES 1) and pull-off protection
- 1 steel security bolt

Special features

- **OIT as a wet room door**
in stainless steel
- **OIT as an apartment entrance door**
break-in-resistant, resistance class 2
- **OIT also with block frame**

AZ 40 Aluminium Internal Door

Modern Architecture Demands Plenty of Light

We recommend these elegant, light-looking yet extremely sturdy aluminium doors for distinguished interiors, for example, in offices and administrative buildings. The variety of versions means that you determine the appearance. The door colours can be harmoniously matched to the interior design scheme. The large areas of glazing create a bright, friendly atmosphere. In terms of both equipment and quality, AZ aluminium doors meet the high standards required of high-grade internal doors in a modern-day environment.



Solid corner joints in the frame give the AZ doors a high degree of stability. The precision mitres and softline glazing beads make for attractive aesthetics.

As a door leaf or door set

AZ 40 doors are available as a ready-to-hang door leaf or as a complete ready-to-fit door set.

Door leaf

Ideal for renovations where a rebated door frame already exists. It comes complete with a fitted lock and galvanized hinge parts.

Door set

For new buildings we recommend using the complete door set together with a frame of your choice selected from Hörmann's wide range of door frames acc. to DIN 18111.

The elegant, sturdy door leaf

A slimline tubular frame construction made from aluminium extrusions.
Depth 40/35 mm
Rebated on 3 sides
Wall thickness 2 mm
Distance to side 105 mm on opposite hinge side (130 mm on hinge side)
Bottom section height 150 mm.
With horizontal rail (130 mm wide) and retractable bottom seal on request.

All frames

Made of 1.5-mm-thick sheet metal, galvanized and primed in Light grey (based on RAL 7035), with sealing profile on 3 sides and fixing material included.

As a corner frame for brickwork, concrete and gas concrete, or as a profile frame for brickwork, concrete, gypsum plasterboard and partition walls.



The quality lock

Mortice lever/knob lock acc. to DIN 18251, class 3, prepared for profile cylinder (backset 55 mm).
With plastic latch, steel bolt and brass coloured painted lock cover, deadlock insert and key.
Also with profile cylinder on request. Illustration: Stainless steel lock cover.



High-grade seals

The door leaf infill slots into EPDM glass rebate seals and is held in place by softline glazing beads.
As a door set with EPDM door frame seal on 3 sides, also with retractable bottom seal on request.



Choice of handle set

With doors as elegant-looking as these, the handle needs to be matched to the colour and glazing of the door leaf, as well as to the interior design. On page 15 we show the handle sets you can choose from.



Illustration:
High-gloss, powder-coated door leaf,
door frame painted in matching colour on-site

As standard:

- **Climatic class III**
- **Duty category S**

Depending on the equipment:

- **Acoustic-rated**
- **Smoke-tight**

Hinge systems to choose

The door leaf is equipped as standard with galvanized hinge parts V0026 WF, which are firmly screwed in. The door leaf and frame are designed for the hinge systems V8000 WF/ V9000 WF.

Further hinge systems are available on request.



Galvanized steel

Stainless steel
V2A

Attractive design

With the round-style frame and Globus hinges, AZ doors have a particularly attractive appearance.



Acoustic-rated

DIN 52210

Special options

For door leaves up to 1125 x 2125 mm, with the following optional extras:

- Retractable bottom seal
- Sealing form parts
- EPDM frame seal
- Laminated safety glass 8 mm or
- Aluminium acoustic-rating panel 18 mm thick
- Mortice lock with profile cylinder.

Acoustic value:

R_w approx. 32 dB (lab value).

Characteristic acoustic rating achievable on-site:

Laboratory value - 5 dB.

Smoke-tight

DIN 18095

Special options

For door leaves up to 1125 x 2250 mm, with the following optional extras:

- Retractable bottom seal
- Sealing form parts
- EPDM frame seal
- Wired glass
- Mortice lock with metallic latch and galvanized lock cover
- Profile cylinder
- Overhead door closer with lever arm

Also suitable for humid environments

System-tested RAL-RG 426
Climatic class III and duty category S.



Doors Are Design Elements Colours Create a Friendly Atmosphere

ZK and OIT steel internal doors

The smooth, high-grade satin matt powder-coating shows the colours of the Hörmann ZK and OIT steel doors at their best. And the top-quality, foil-coated timber designs have natural-looking appearances. Both surface finishes are highly durable and easy to maintain.



Galvanized



Traffic white (similar to RAL 9016)



Light grey (similar to RAL 7035)



Pigeon blue (similar to RAL 5014)



Sepia brown

Our ZK and OIT steel internal doors are available in the colours on the RAL colour chart and in further timber designs on request.

OIT doors are also available in stainless steel.

Most of the lever handle sets on the doors shown are special equipment.

The colours and surface finishes shown are subject to the limitations of the printing process and cannot be regarded as binding.



Light ivory



Window grey (similar to RAL 7040)



White Ash



Cherry



Light Oak



Natural Oak



Beech



Dark Oak // NEW



Golden Oak



Rosewood

AZ 40 aluminium internal door

The diversity of the surface finishes is a distinguishing feature of Hörmann's AZ 40 aluminium internal doors. It is available anodised or powder-coated in RAL colours, as well as chromated for on-site painting.



Window grey (similar to RAL 7040)



Pale green (similar to RAL 6021)



Door Glazings for Brighter Rooms



ZK/OIT door
Round glazing
Ø 300 mm or 400 mm
Aluminium glazing frame
anodized in natural
finish (E6/EV1), in brushed
stainless steel on request
(illustrated).



ZK/OIT door
Glazing cut-out view 5
Glazing frame with
galvanized door leaves:
aluminium (paintable).



ZK/OIT door
Glazing cut-out view 6
Glazing frame with
powder-coated door leaf:
Aluminium anodised in
natural finish (E6/EV1).



ZK/OIT door
Glazing cut-out view 7
Glazing frame with foil-
coated door leaf: stained
timber, matching the door
leaf.



AZ 40 door
Glazing over the entire
surface or divided by
horizontal rail, e.g. top
glass, bottom panel
(page 12).

All Hörmann internal doors are also available with glazing on request. If glazing is to be fitted on-site, please note the following pane thicknesses:

- ZK and OIT doors (pane thickness 4-6 mm),
- AZ 40 doors (pane thickness 4-18 mm).

Round glazing for ZK and OIT doors can only be fitted at the factory.

For further details please refer to the texts for invitation of tenders.



Masterpoint ornamental
glass



Mastercarré ornamental
glass



Masterligne ornamental
glass

A wide range of glass types

ZK and OIT doors are available at the factory in the structures shown: light 7 mm wired ornamental glass, 6 mm single-pane or laminated safety glass, or 6 mm ornamental glass.

AZ 40 doors are also available with 4 mm ornamental glass, 9 mm ornamental compound glass, 18 mm insulated glass and a 10 mm aluminium panel infill.

For AZ 40 doors featuring a horizontal rail, the panel infill can also be combined with glazing.

Wide-angle spyhole

Spyhole preparation Ø 15 mm. Fitting also available on-site.

Letter drop flap

245 x 53 mm with cover

Ventilation grille

Plastic grille 435 x 85 mm. Positioned at the bottom, top, or on request at the top and bottom of the door.

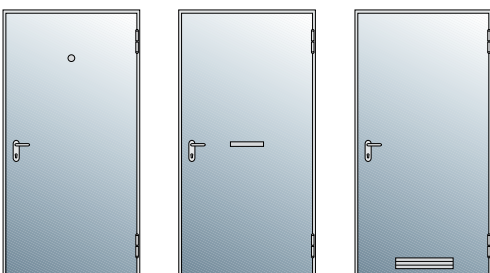

Optional extras for ZK and OIT steel internal doors

Handle Sets Create Attractive Accents

Plastic handle sets

Lever handle and lever/knob handle sets (lever handle securely fitted) in black, red, brown, white and yellow.

Also with anti-panic function.

For AZ 40 doors also in all HEWI colours.

ZK/OIT

AZ-40



Lever handle set, PZ/BB



Lever handle set, PZ rose escutcheon

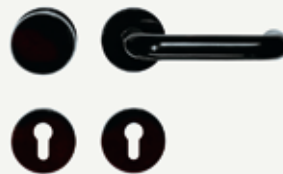

Lever/knob handle set, PZ rose escutcheon



Lever/knob handle set, PZ rose escutcheon

Aluminium handle sets

Offered in the same versions as the plastic handle sets, anodized in natural finish (F1), also with anti-panic function on request.



Lever handle set, PZ rose escutcheon



Lever handle set, PZ rose escutcheon



Lever/knob handle set, PZ



Lever/knob handle set, PZ rose escutcheon

Stainless steel handle sets

Offered in the same versions as the plastic and aluminium handle sets.

Also with anti-panic function.



Lever handle set, PZ rose escutcheon



Lever handle set, PZ rose escutcheon



Lever/knob handle set, PZ



Lever/knob handle set, PZ rose escutcheon

It goes without saying that Hörmann internal doors can also be equipped with all other proprietary lever handle sets.

PZ = profile cylinder
BB = deadlock

Dimensions and Fitting Data

ZK Steel Internal Door

OIT Steel/Timber Internal Door

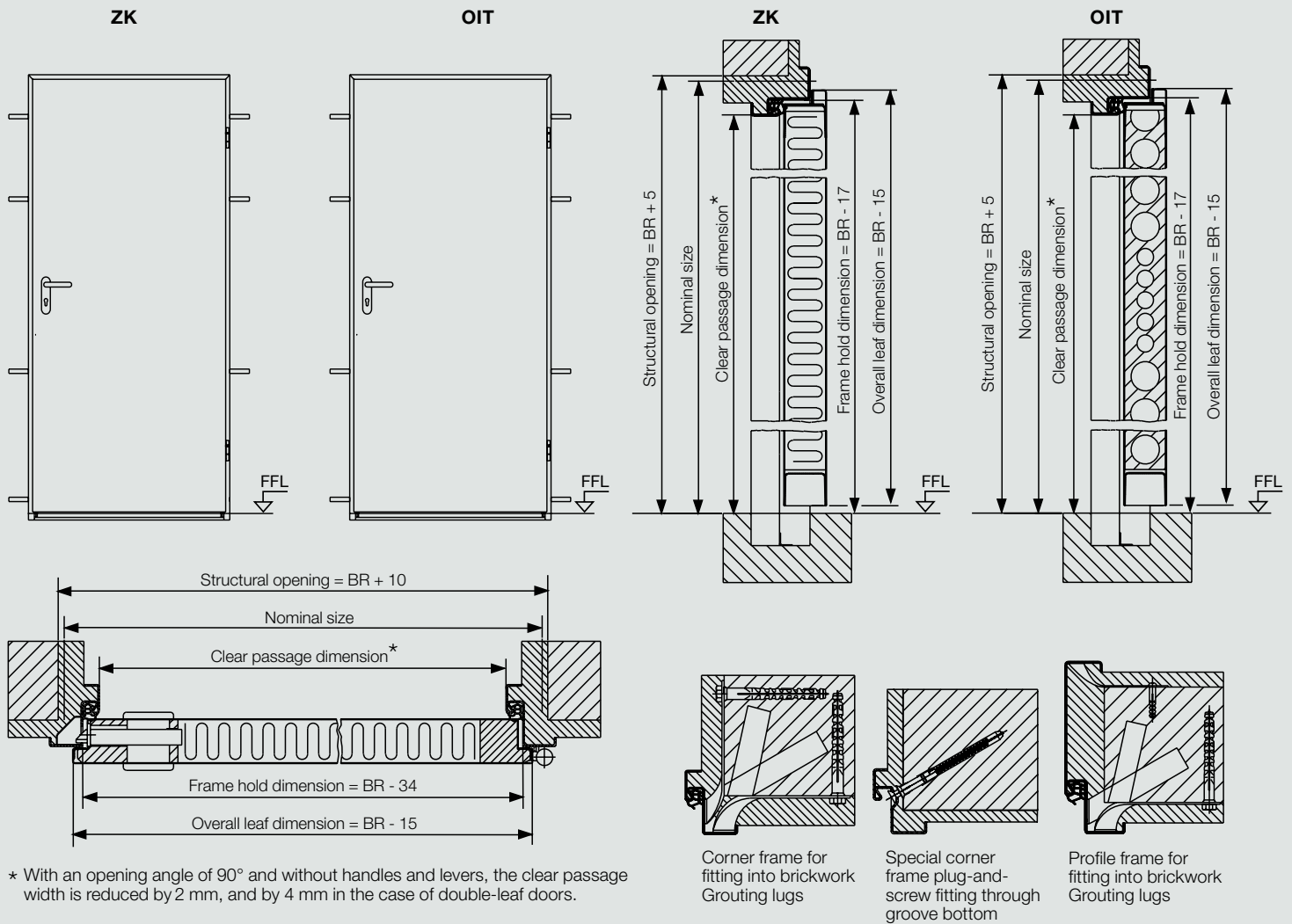

Standard sizes

Type	Ordering size Nominal size Width x height	Structural opening Width x height	Clear passage dimension Width x height	Frame hold dimension Width x height	Overall door leaf dimension Width x height	Clear view***		
						View 5 Width x height	View 6 Width x height	View 7 Width x height
Single-leaf	625 x 2000	635 x 2005	561 x 1968	591 x 1983	610 x 1985	200 x 375	200 x 950	200 x 1305
	750 x 1875	760 x 1880	686 x 1843	716 x 1858	735 x 1860	325 x 375	325 x 950	325 x 1305
	750 x 2000	760 x 2005	686 x 1968	716 x 1983	735 x 1985	325 x 375	325 x 950	325 x 1305
	750 x 2125	760 x 2130	686 x 2093	716 x 2108	735 x 2110	325 x 375	325 x 950	325 x 1305
	875 x 1875	885 x 1880	811 x 1843	841 x 1858	860 x 1860	450 x 375	450 x 950	450 x 1305
	875 x 2000	885 x 2005	811 x 1968	841 x 1983	860 x 1985	450 x 375	450 x 950	450 x 1305
	875 x 2125	885 x 2130	811 x 2093	841 x 2108	860 x 2110	450 x 375	450 x 950	450 x 1305
	1000 x 1875	1010 x 1880	936 x 1843	966 x 1858	985 x 1860	575 x 375	575 x 950	575 x 1305
	1000 x 2000	1010 x 2005	936 x 1968	966 x 1983	985 x 1985	575 x 375	575 x 950	575 x 1305
1000 x 2125	1010 x 2130	936 x 2093	966 x 2108	985 x 2110	575 x 375	575 x 950	575 x 1305	
Double-leaf **	1500 x 2000	1510 x 2005	1436 x 1968	1466 x 1983	1485 x 1985	325 x 375	325 x 950	325 x 1305
	1750 x 2000	1760 x 2005	1686 x 1968	1716 x 1983	1735 x 1985	450 x 375	450 x 950	450 x 1305
	2000 x 2000	2010 x 2005	1936 x 1968	1966 x 1983	1985 x 1985	575 x 375	575 x 950	575 x 1305
	2000 x 2125	2010 x 2130	1936 x 2093	1966 x 2108	1985 x 2110	575 x 375	575 x 950	575 x 1305

Size range of nominal sizes

Single-leaf

Width up to max. 1250 mm
Height up to max. 2250 mm

Double-leaf

Width up to max. 2500 mm
Height up to max. 2250 mm

Glass size:

Clear view of table, width + 20 mm,
height + 20 mm

Please state handing on order!

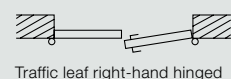
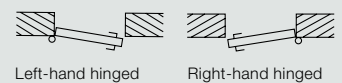

** Symmetrical division of leaves

*** Glazing cut-out in special sizes on request

Dimensions and Fitting Data AZ 40 Aluminium Internal Door

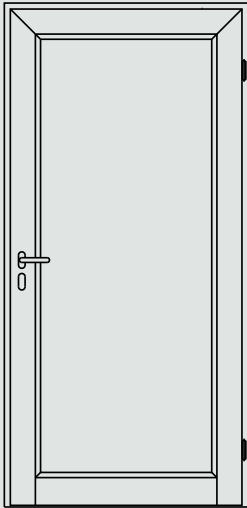

As standard, single-pane

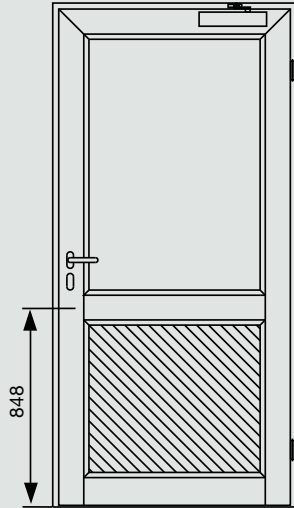

On request with horizontal rail and overhead door closer (an overhead door closer is compulsory for smoke-tight doors).

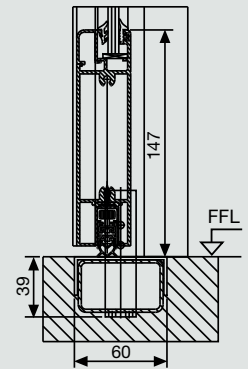
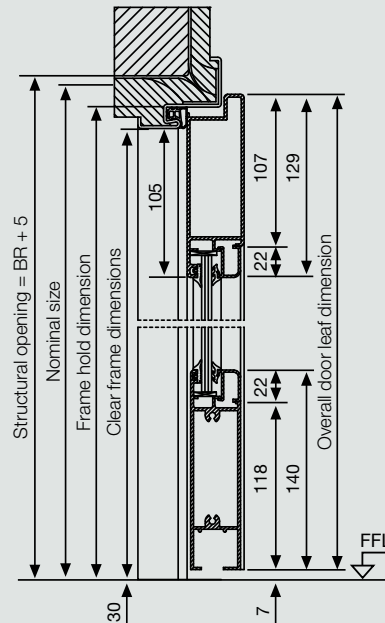

As standard without threshold, with retractable bottom seal on request.

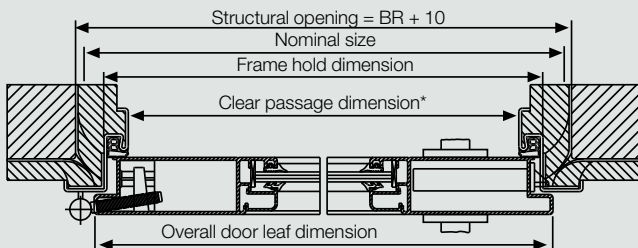

With corner frame

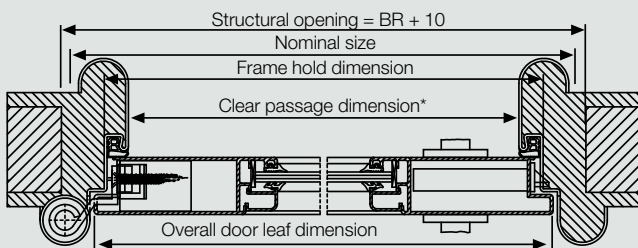

With round-style door frame and Globus hinge

* With an opening angle of 90° and without taking into account handles or levers, the clear passage width is reduced by 15 mm.

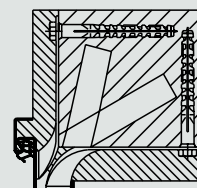

Corner frame for fitting into brickwork Grouting lugs.

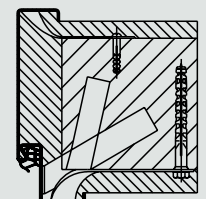

Profile frame for fitting into brickwork Grouting lugs.

Standard sizes*

Ordering size Nominal size Width x height	Structural opening Width x height	Clear passage dimension Width x height	Frame hold dimension Width x height	Overall door leaf dimension Width x height	Glass dimensions Width x height
750 x 2000	760 x 2005	686 x 1968	716 x 1983	735 x 1985	501 x 1739
875 x 2000	885 x 2005	811 x 1968	841 x 1983	860 x 1985	626 x 1739
1000 x 2000	1010 x 2005	936 x 1968	966 x 1983	985 x 1985	751 x 1739
750 x 2125	760 x 2130	686 x 2093	716 x 2108	735 x 2110	501 x 1864
875 x 2125	885 x 2130	811 x 2093	841 x 2108	860 x 2110	626 x 1864
1000 x 2125	1010 x 2130	936 x 2093	966 x 2108	985 x 2110	751 x 1864

Size range

Ordering dimensions

Width: 750 - 1250 mm
Height: 1875 - 2250 mm

Please state handing on order!

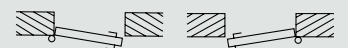

Left-handed hinged Right-handed hinged

* Refers to door sets with steel frames according to DIN 18111



Practical for your construction project planning: One partner for all your needs.



Fully glazed fire and smoke protection elements

Hörmann delivers a wide range of fully glazed smoke-tight, T30 and T90 tubular frame parts. You can choose between three different models: the steel S-line, steel N-line and aluminium. All of these models have matching appearances and are available up to a maximum height of 4.5 m. The side assemblies make an infinite number of widths possible.



Visibility glazings

Hörmann visibility glazings are used as windows or room-high elements to provide more light and improved visibility. Visibility glazing is also available for special requirements, i.e. in heat and acoustic insulation or radiation-proof versions, as well as in the fire-retarding F30 and fire-resistant F90 variants. Individual solutions can be implemented using rail divisions and angles.

Steel frames

As a frame specialist with decades of experience, Hörmann caters to your desires and can even implement special solutions for every structural situation.



Multi-function steel doors

Steel doors from Hörmann are more than just functional. They are characterised by their matching appearance. The advantage for architects and building owners: Doors that fulfil different functional requirements and are fitted on the same floor are perfectly suited to one another.



Flush-fitting steel fire doors

The most obvious feature of these steel fire doors is a flush-fitting, elegant and matching appearance in the T30, T90 and smoke-tight versions. Also available in a stainless steel version. On request, these doors also come with individual glazing, a concealed door closer, a panic function acc. to DIN, monitoring contacts, and an electric door strike.

Further information can be found in the brochures.

// High-acoustic-rated steel door with up to 53 dB

Multi-function steel doors
 Fire and smoke-tight doors
 Acoustic-rated doors
 Security doors
 Multi-purpose doors

// The optimum solution for fitting in solid and partition walls

Steel frames
 A comprehensive, high-quality programme

// A world's first smoke-tight T30 automatic sliding door

Fire rated and smoke-tight door assemblies
 For comprehensive solutions in construction projects

// The comprehensive programme for interior windows

Visibility window
 For all your insulation, acoustic rating and UV protection requirements, as well as laminated glassing

// Attractive fire protection, also in stainless steel

Steel fire/smoke-tight doors
 Flush-glazed over the entire surface

Hörmann: Quality without Compromise



Hörmann KG Amshausen



Hörmann KG Antriebstechnik



Hörmann KG Brandis



Hörmann KG Brockhagen



Hörmann KG Dissen



Hörmann KG Eckelhausen



Hörmann KG Freisen



Hörmann KG Ichtershhausen



Hörmann KG Werne



Hörmann Genk NV, Belgium



Hörmann Alkmaar B.V., Netherlands



Hörmann Legnica Sp. z o.o., Poland



Hörmann Beijing, China



Hörmann Tianjin, China



Hörmann LLC, Montgomery IL, USA



Hörmann Flexon, Leetsdale PA, USA

Hörmann is the only manufacturer worldwide that offers you a complete range of all major building products from one source. We manufacture in highly-specialised factories using the latest production technologies. The close-meshed network of sales and service companies throughout Europe, and activities in the USA and China, make Hörmann your strong partner for first-class building products, offering “Quality without Compromise”.

GARAGE DOORS

OPERATORS

INDUSTRIAL DOORS

LOADING EQUIPMENT

HINGED DOORS

DOOR FRAMES

Hörmann (UK) Ltd, Gee Road, Coalville, Leicestershire LE67 4JW
Phone (01530) 513000, Fax (01530) 513001

